

NORTH CAROLINA DEPARTMENT OF TRANSPORTATION

PROPOSED ROADSIDE ENVIRONMENTAL LANDSCAPE DESIGN & AESTHETICS PROJECT

T.I.P. #	FEDERAL PROJECT W.B.S. #	SHEET #	SHEET # TOTAL
I-0911A (L)		L1A	11
FED. PROJ. #	DESCRIPTION		DIVISION
00000.000.000			9

LANDSCAPE Enhancements & Aesthetics

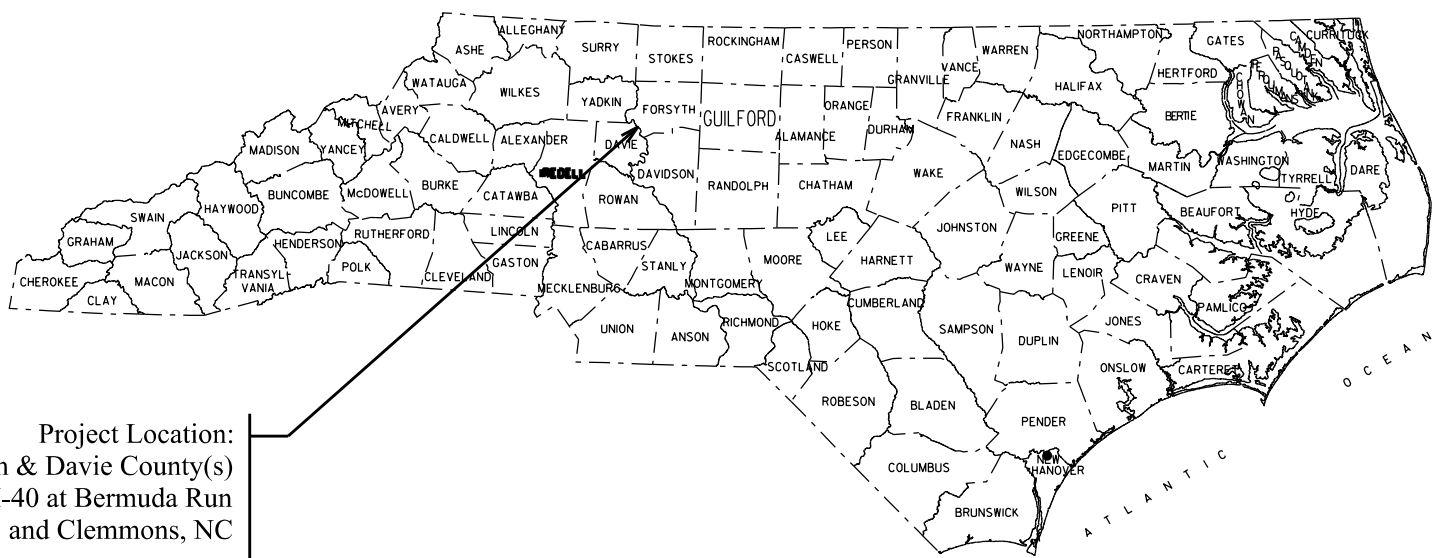

Summary of Quantities

QUANTITY	UNIT	KEY	BOTANICAL NAME	COMMON NAME	FURNISH
Small Flowering Trees (LARGE)					
134	EA	CCL	<i>Cercis canadensis</i>	Redbud	1 1/2-2" Cal., 6-8', B&B, Specimen As Shown
113	EA	CVL	<i>Chionathus virginicus</i>	Fringetree	1 1/2-2" Cal., 6-8', B&B, Specimen As Shown
82	EA	CWL	<i>Crataegus viridis</i> 'Winter King'	Washington Harthorne	1 1/2-2" Cal., 6-8', B&B, Specimen As Shown
Evergreen Trees (LARGE)					
98	EA	CJL	<i>Cryptomeria japonica</i> 'Yoshino'	Yoshino Cryptomeria	6-8', B&B, Specimen 3.1.2.4 As Shown
127	EA	CAL	<i>Cupressus arizonica</i> 'Carolina Sapphire'	Carolina Sapphire Cypress	6-8', B&B, Specimen 3.1.2.4 As Shown
22	EA	INL	<i>Ilex X 'Nellie R Stevens'</i>	Nellie Stevens Holly	#7 CONT. Specimen 3.1.2.4 As Shown
206	EA	JVL	<i>Juniperus virginiana</i>	Eastern Red Cedar	6-8', B&B, Specimen 3.1.2.4 As Shown
25	EA	MGL	<i>Magnolia grandiflora</i> 'D.D. Blancher'	D.D. Blancher Magnolia	6-8', B&B, Specimen 3.1.2.4 As Shown
Deciduous Trees (LARGE)					
14	EA	ABL	<i>Acer rubrum</i> 'Autumn Blaze'	Autumn Blaze Red Maple	1 1/2-1 3/4" Cal., 10-12', B&B, Specimen As Shown
17	EA	ARL	<i>Acer rubrum</i> 'October Glory'	October Glory Red Maple	1 1/2-1 3/4" Cal., 10-12', B&B, Specimen As Shown
25	EA	NSL	<i>Nyssa sylvatica</i> 'Wildfire'	Black Gum	1 1/2-1 3/4" Cal., 10-12', B&B, Specimen As Shown
34	EA	QAL	<i>Quercus alba</i>	White Oak	1 1/2-1 3/4" Cal., 10-12', B&B, Specimen As Shown
40	EA	QCL	<i>Quercus coccinea</i>	Scarlet Oak	1 1/2-1 3/4" Cal., 10-12', B&B, Specimen As Shown
27	EA	QSL	<i>Quercus shumardii</i>	Shumard Oak	1 1/2-1 3/4" Cal., 10-12', B&B, Specimen As Shown
21	EA	TDL	<i>Taxodium distichum</i>	Bald Cypress	1 1/2-1 3/4" Cal., 10-12', B&B, Specimen As Shown
Shrubs / Native Grass and Perennial Varieties					
1875	EA	EP	<i>Echinacea purpurea</i>	Purple Coneflower	QT, 2' O.C.
6100	EA	ES	<i>Eragrostis spectabilis</i>	Purple Love Grass	32s - 32 liners per tray 2' O.C.
8530	EA	HB	<i>Hemerocallis</i> 'Buttered Popcorn'	Buttered Popcorn Daylily	Single Fan Rhizome 2' O.C.
20,535	EA	ND	<i>Narcissus</i> 'Dutch Master'	Dutch Master Daffodil	DN II 24" O.C.
15,270	EA	NT	<i>Nassella tenuissima</i>	Mexican Feather Grass	32s - 32 liners per tray 2' O.C.
2325	EA	PV	<i>Panicum virgatum</i> 'Cloud Nine	Cloud Nine Switchgrass	32s - 32 liners per tray 5' O.C.
3495	EA	RF	<i>Rudbeckia fulgida</i> 'Goldstrum'	Black Eyed Susan	QT, 2' O.C.
1200	EA	SS	<i>Schizachyrium scoparium</i>	Little Bluestem	32s - 32 liners per tray 2' O.C.
Descriptions					
12	EA	SP	Establishment		
4700	CY	1670	Mulch for Planting		
165	CY	SP	River Stone		
36,500	SY	1670	Post-Emergence Herbicidal Treatment for Plant Beds		
36,500	SY	1670	Pre-Emergence Plant Bed Herbicide Treatment		
370	M/G	1670	Water for Planting		
10	CYCLES	SP	Specialty Mowing		
1	LS	1101	Traffic Control		
1	ACRE	1651	Selective Vegetation Removal		
1	LS	SP	Landscape Grading		
16.5	ACRE	SP	Supplemental Seeding		
50	CY	SP	Topsail		

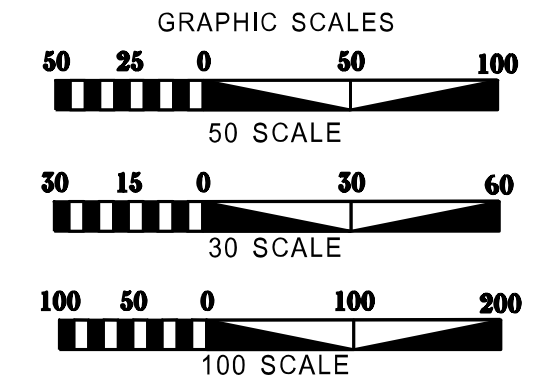

Designed By: Jeff Lackey 3/2023

REVISIONS

DATE	DESCRIPTION

INDEX OF (L) SHEETS:

- L1A - TITLE SHEET
- L1B - PLANTING DETAILS
- L1C - SHEET LAYOUT PLAN / SYMBOLOGY

- (BERMUDA RUN INTERCHANGE)
- L2 - LANDSCAPE PLANTING PLAN
- L3 - LANDSCAPE PLANTING PLAN
- L4 - LANDSCAPE PLANTING PLAN

- L5 LANDSCAPE PLANTING PLAN
- L6 - LANDSCAPE PLANTING PLAN
- L7 LANDSCAPE PLANTING PLAN

- (CLEMMONS HARPERS RD INTERCHANGE)
- L8 - LANDSCAPE PLANTING PLAN
- L9 - LANDSCAPE PLANTING PLAN

- L10 - LANDSCAPE PLANTING PLAN

CONVENTIONAL SYMBOLS

County Line	-----
City or Town Line	- - - - -
Exist. Right of Way Line Marker	----- Δ -----
Prop. Right of Way Line Marker (By Others)	----- ▲ -----
Prop Right of Way Line Marker (By Contract)	----- ◆ -----
Exist. Control of Access Line	----- ⊕ -----
Prop. Control of Access Line	----- ⊖ -----
Property Line	----- E -----
Easement Line	----- E -----
Slope Stake Line	----- S -----
Exist. Fence	----- + -----
Prop. Woven Wire Fence	----- ○ -----
Prop. Chain Link Fence	----- □ -----
Exist. Road	----- = -----
Prop. Road	----- = -----
Guardrail	----- T -----
Survey Line	----- + -----
Denotes Line Equality	----- ⊕ -----
Bridge	----- ⊕ -----
Culvert	----- ⊖ -----
Railroad	----- ⊖ -----
Woods	----- * -----
Exist. Telephone Pole	----- ● -----
Prop. Telephone Pole	----- ○ -----
Tower Pole and Line	----- ⊕ -----
Exist. Power Pole	----- ● -----
Prop. Power Pole	----- ○ -----
Sanitary Sewer Line	----- → -----
Water Line	----- -----
Gas Line	----- -----
Picnic Shelter	----- □ -----
Regeneration	----- X -----
Reforestation	----- X -----
Large Deciduous Tree	----- ○ -----
Evergreen Tree	----- ● -----
Small or Flowering Tree	----- ○ -----
Shrubs	----- ○ -----
Planting Bed	----- ○ -----

PROJECT: I-0911A(L)

STATE OF
NORTH CAROLINA
DEPARTMENT OF TRANSPORTATION

LOCATION: West of NC 801 in Davie County to East of SR 1101(HarperRoad)
IN FORSYTH COUNTY & DAVIE COUNTY

TYPE of WORK: LANDSCAPE Corridor Enhancement Design & Development

COUNTY: **FORSYTH & DAVIE COUNTY(S)**

2018 STANDARD SPECIFICATIONS

PREPARED IN THE OFFICE OF:
NCDOT- ROADSIDE ENVIRONMENTAL UNIT
DESIGN & DEVELOPMENT SECTION
1557 MAIL SERVICE CENTER
RALEIGH NC 27699 919-707-2920

07/09/97

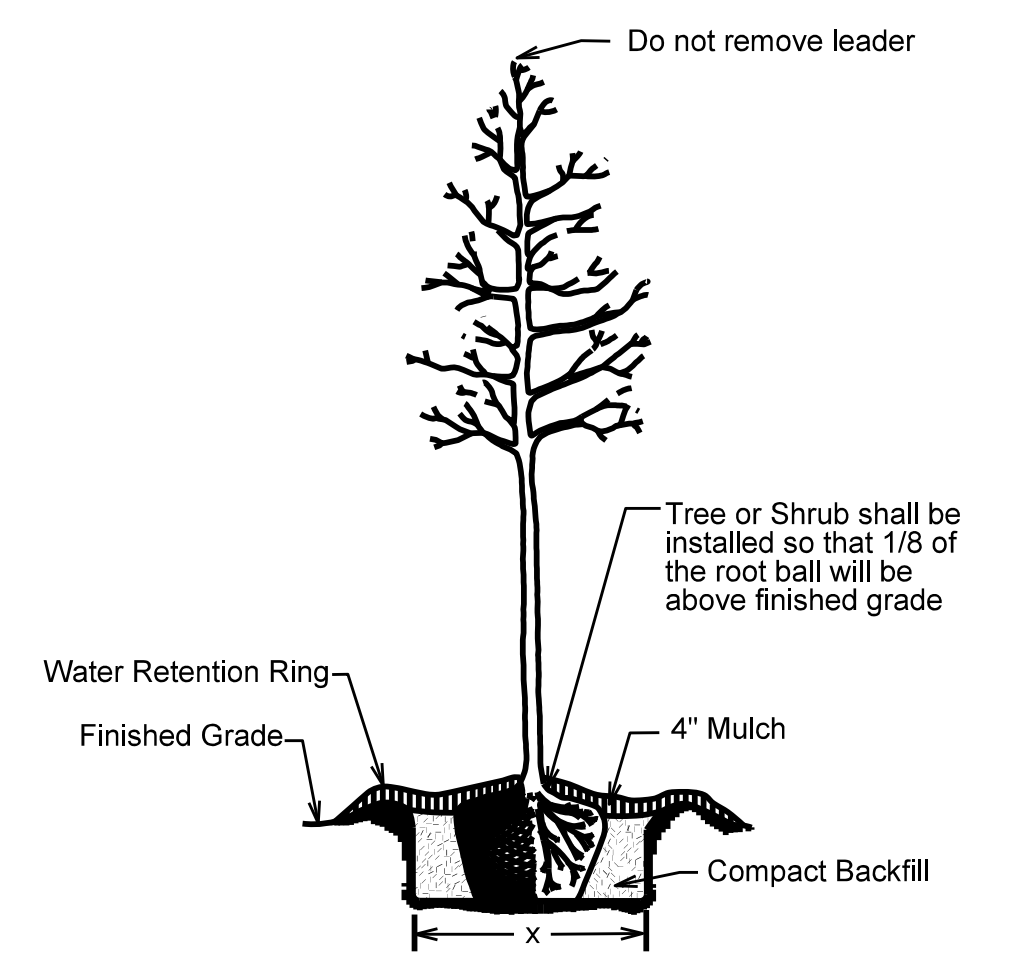

TREE OR SHRUB PLANTING DETAIL
(LEVEL GROUND)

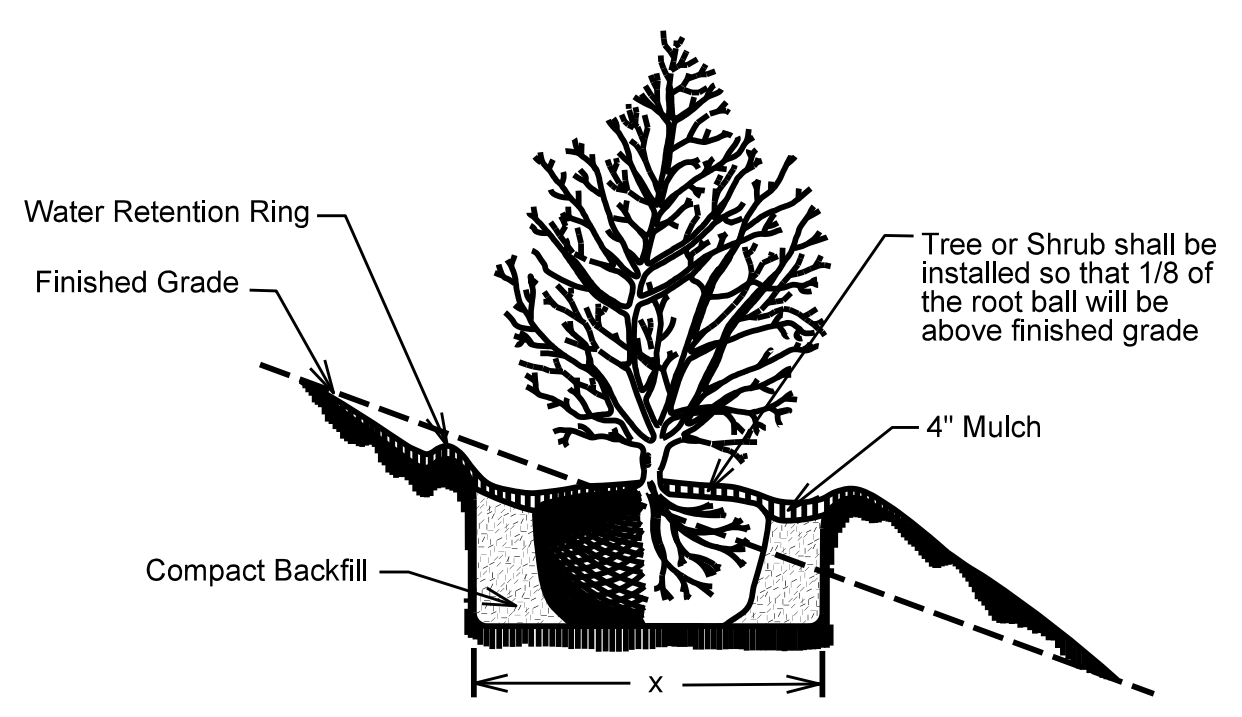

TREE OR SHRUB PLANTING DETAIL
(SLOPING GROUND)

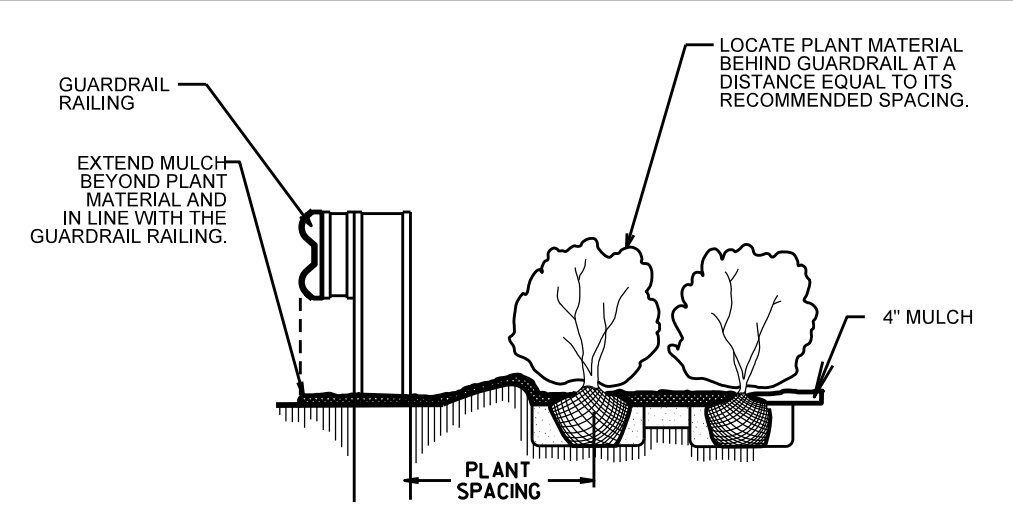

GUARDRAIL MULCHING DETAIL
* Detail to be used when approved by the Engineer.

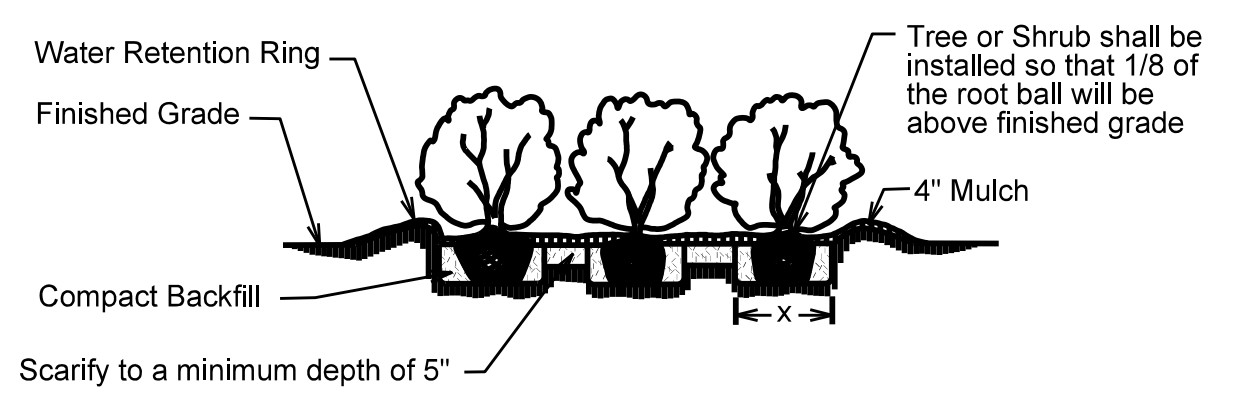

Shrub Bed Planting Detail

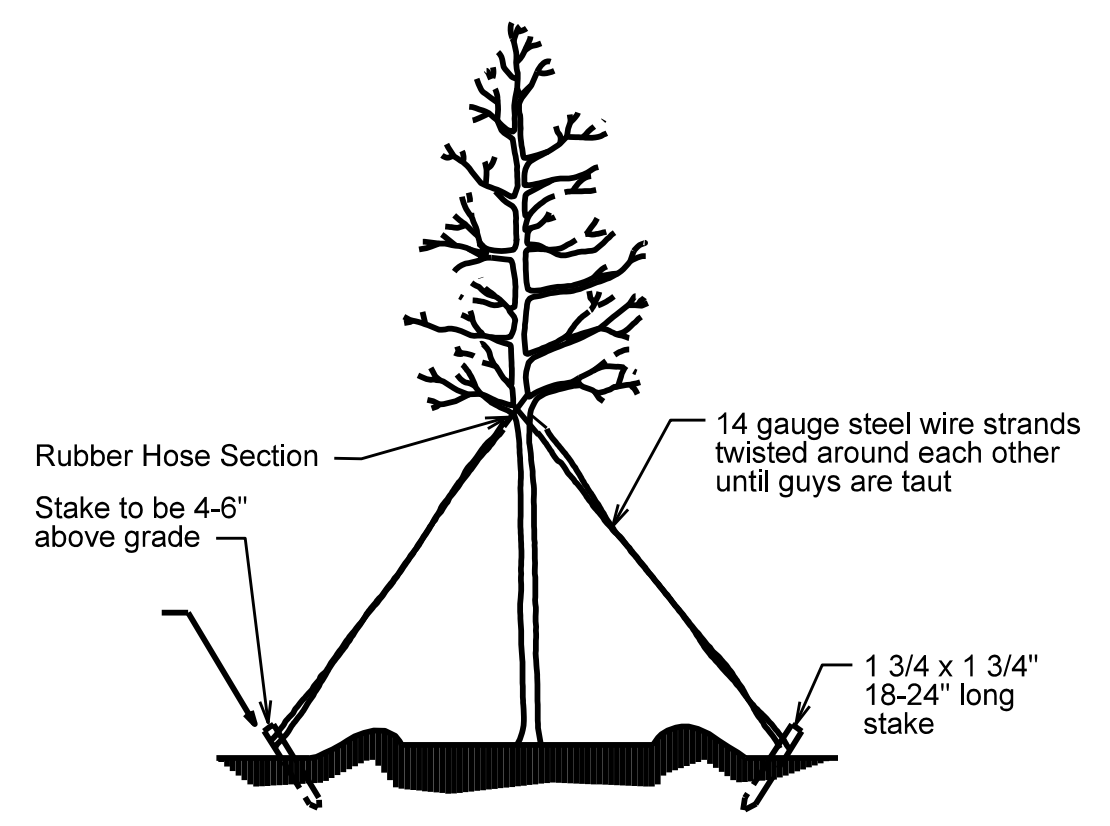

TREE GUYING DETAIL
(FOR TREES 10' OR LARGER)
* Utilize guying detail only if requested by the Engineer.

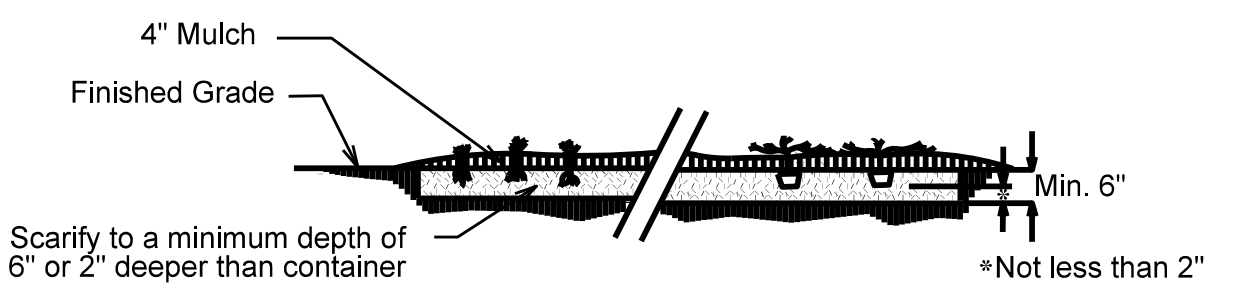

Groundcover Planting Detail

Align Grasses around the edge of plant bed to establish GRID. Start center of grasses & perennials half the spacing distance from edge of plant bed

Establish the O.C. Grid for Grasses & Perennials. See Plant List for individual spacing.

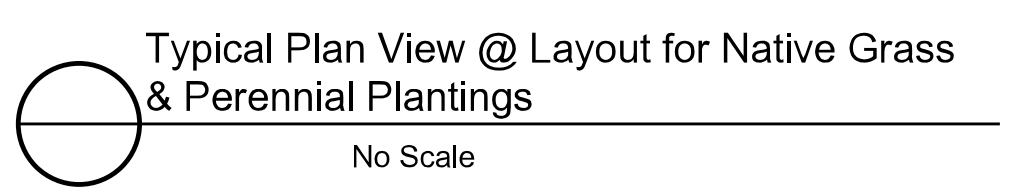

Install the Daffodils in the established 6\"/>

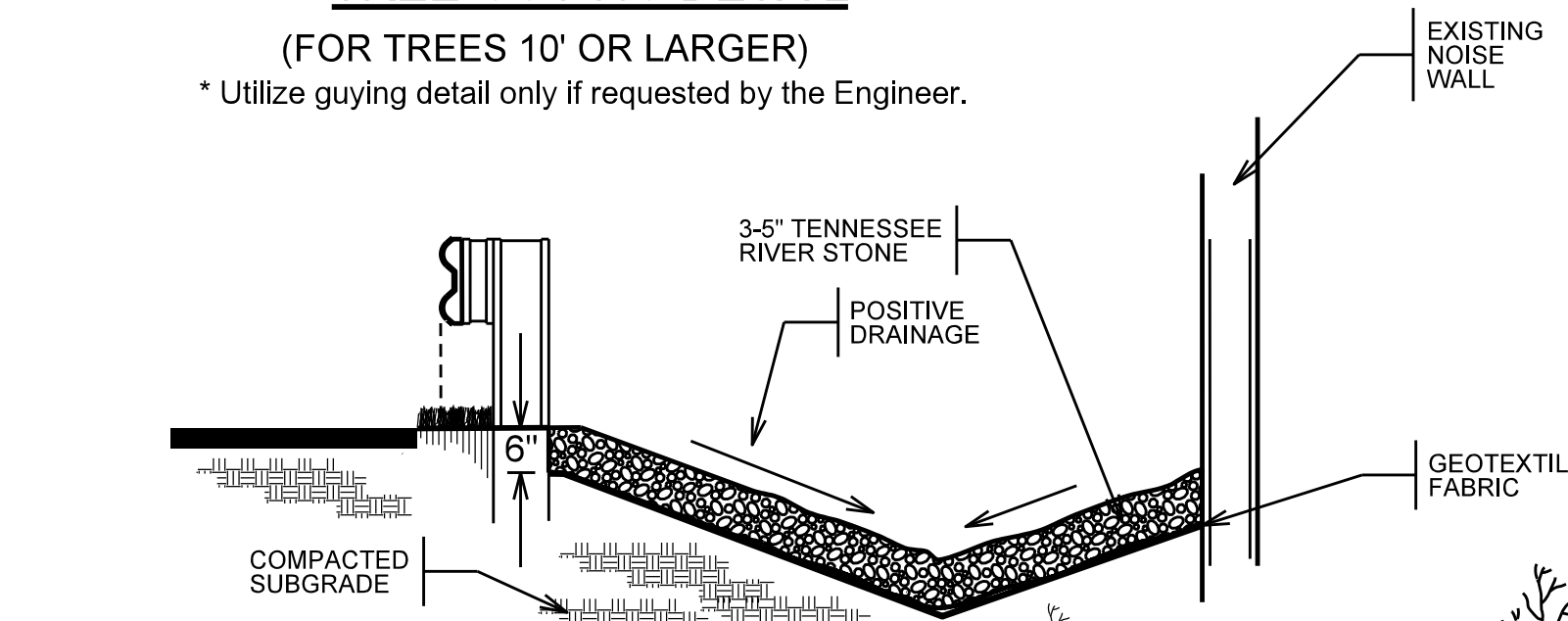

River Stone Detail
No Scale

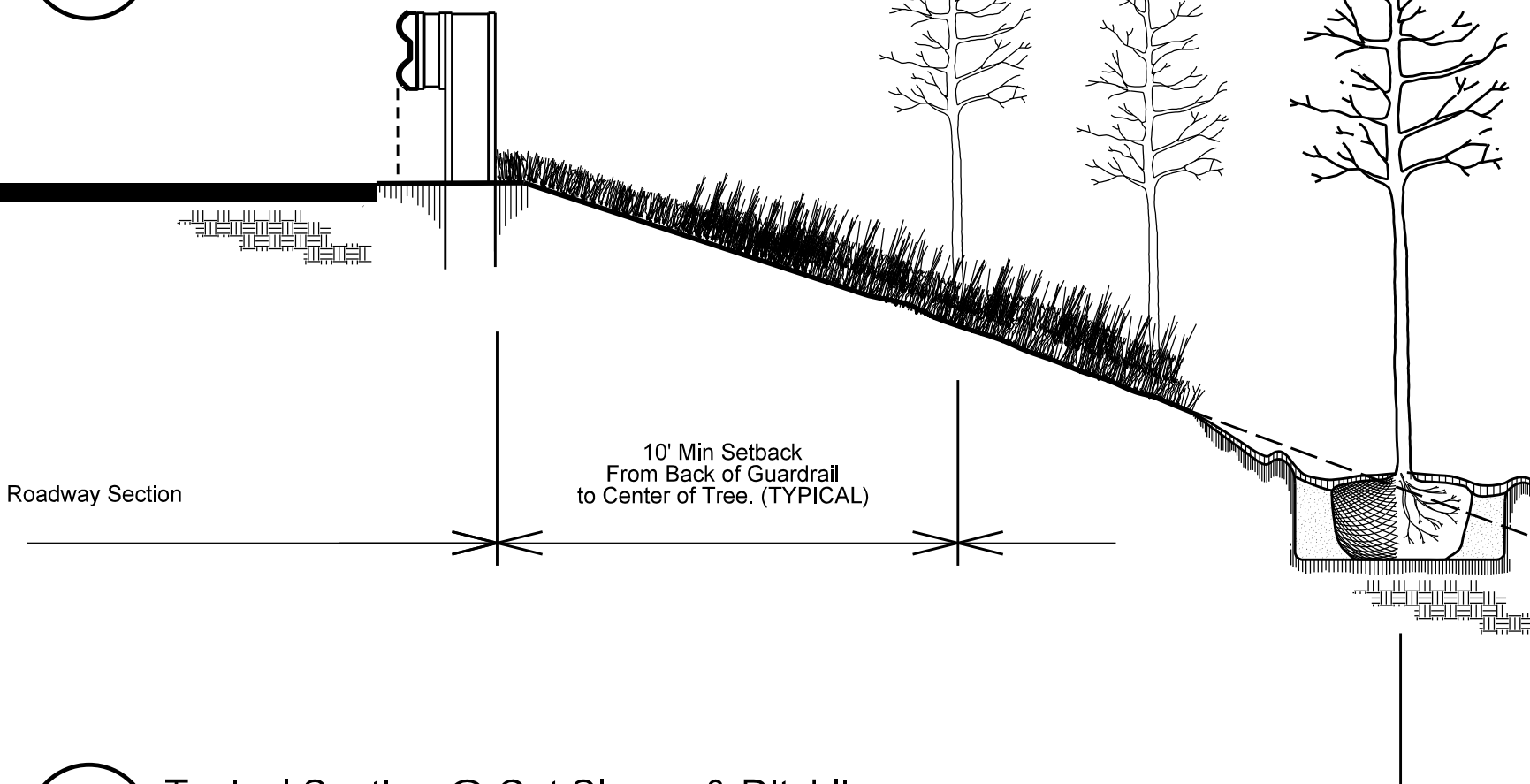

Typical Section @ Cut Slopes & Ditchlines
No Scale

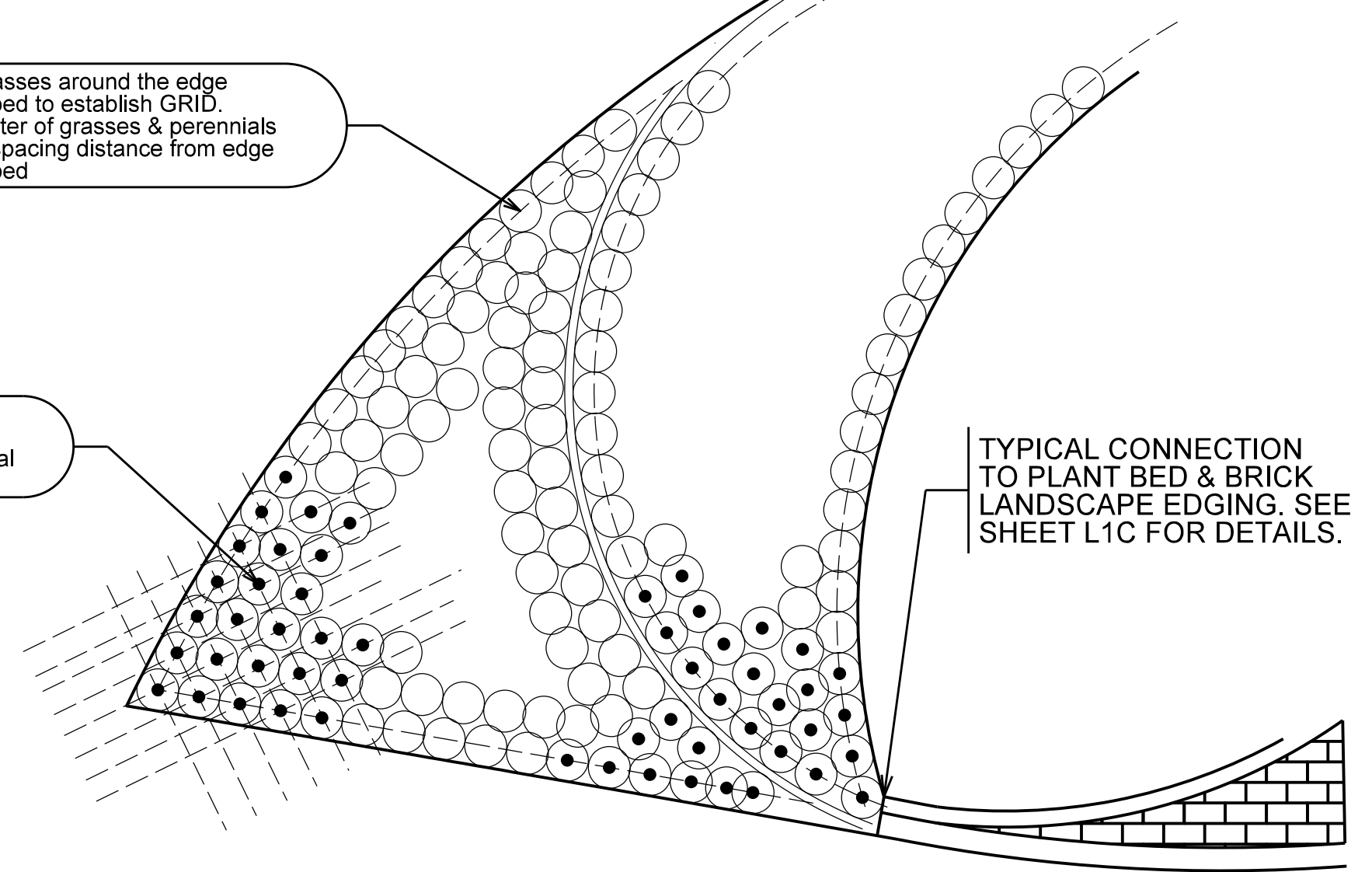

TYPICAL CONNECTION TO PLANT BED & BRICK LANDSCAPE EDGING. SEE SHEET L1C FOR DETAILS.

NOTES:

SCHEDULE FOR PLANT HOLE SIZE:
CONTAINER OR ROOT BALL SIZE
X = 2 TIMES THE DIAMETER OF THE CONTAINER OR THE ROOT BALL DIAMETER

FERTILIZER SHALL BE APPLIED AT TIME OF PLANTING. FERTILIZER SHALL BE A SLOW RELEASE PELLET OR TABLET. FORMULATION SHALL BE APPROVED BY ENGINEER IN THE FIELD.

RATES SHALL BE PER MANUFACTURERS RECOMMENDATIONS AND APPROVED BY THE ENGINEER IN THE FIELD. THOROUGHLY MIX WITH TOPSOIL, BACKFILL OR SCARIFIED SOIL.

REMOVE BURLAP FROM TOP OF BALL BEFORE BACKFILLING AROUND BALL IS COMPLETE

SEE STANDARD SPECIFICATIONS FOR PLANT BED HERBICIDE TREATMENT

When mulched bed is adjacent to guard rail run mulch to front edge of guard rail - see detail

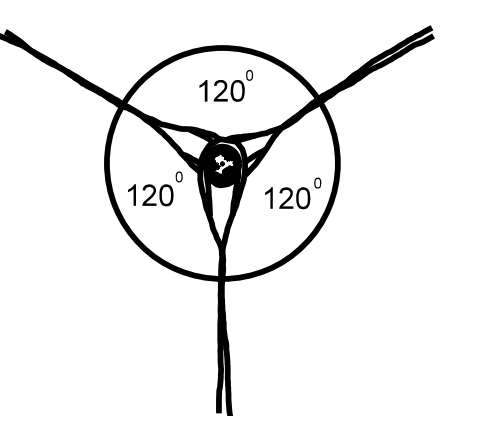
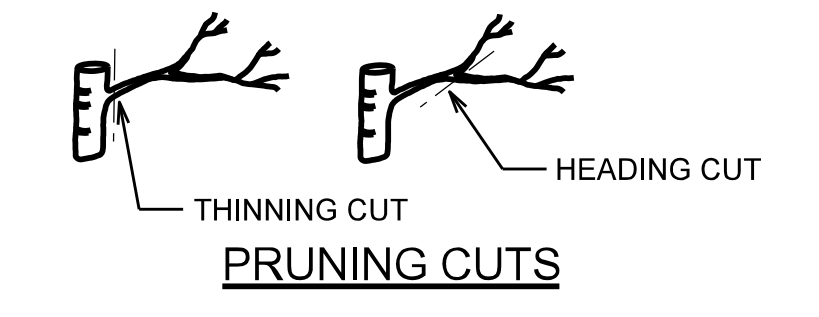

GUY SPACING DETAIL

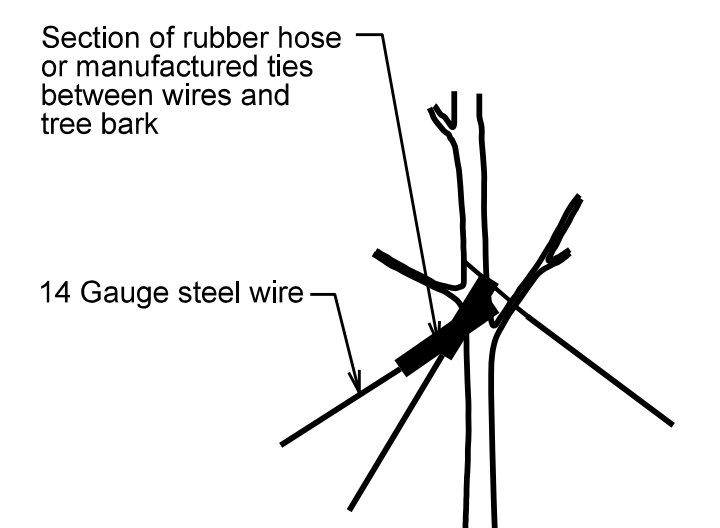

GUY TYING DETAIL

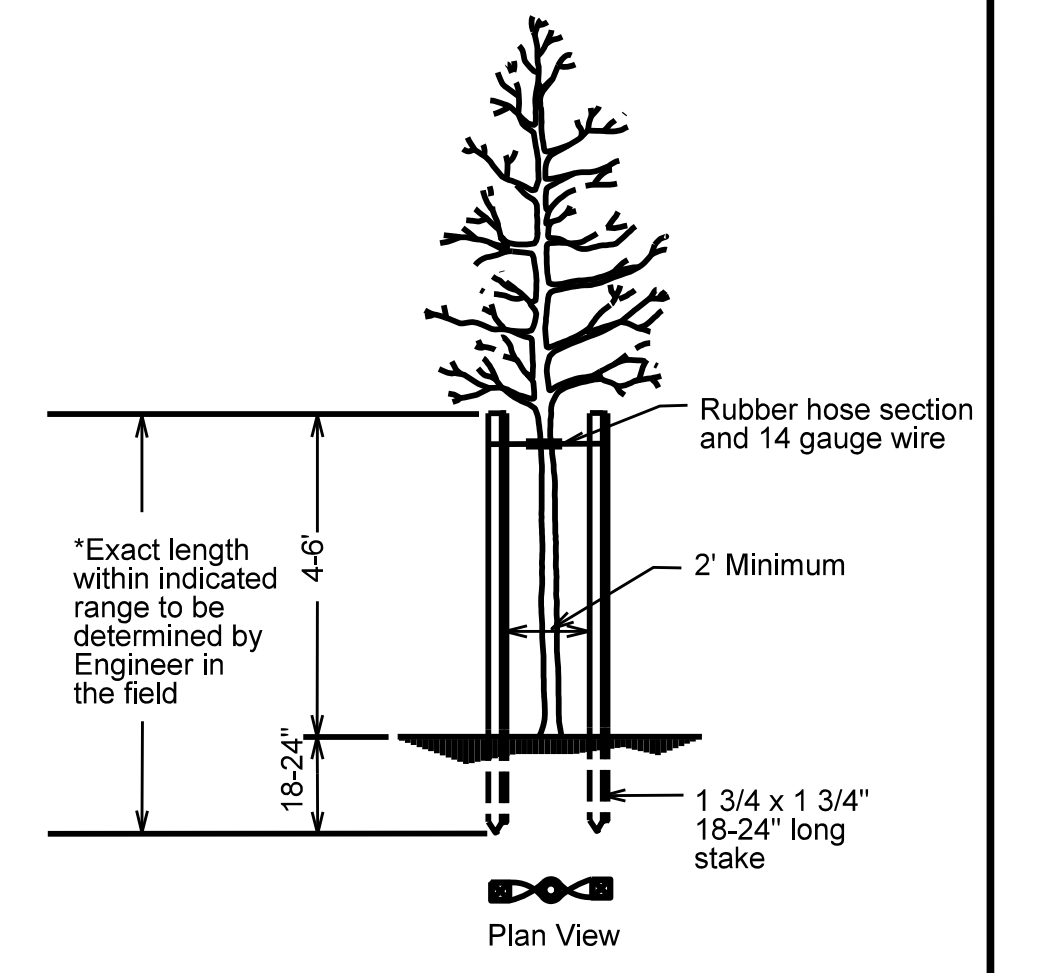

STAKING DETAIL
(FOR TREES 6' TO 10')
* Utilize staking detail only if requested by the Engineer.

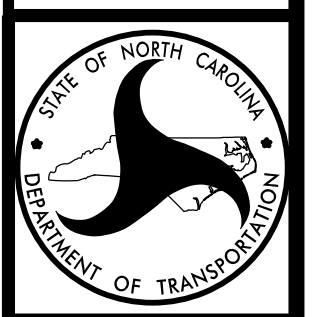

07/09/97

2

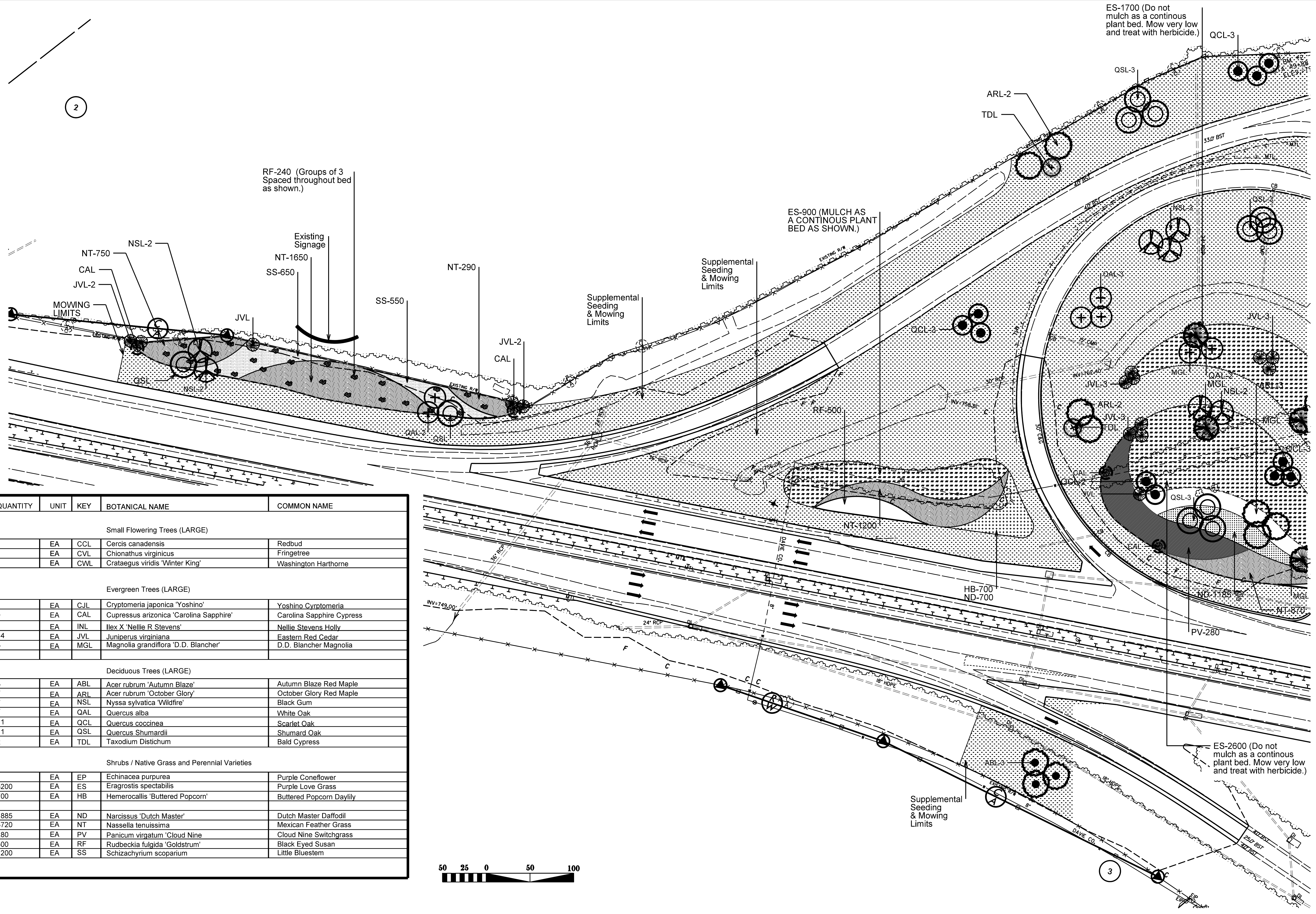

QUANTITY	UNIT	KEY	BOTANICAL NAME	COMMON NAME
Small Flowering Trees (LARGE)				
	EA	CCL	<i>Cercis canadensis</i>	Redbud
	EA	CVL	<i>Chionathus virginicus</i>	Fringetree
	EA	CWL	<i>Crataegus viridis</i> 'Winter King'	Washington Harthorne
Evergreen Trees (LARGE)				
	EA	CJL	<i>Cryptomeria japonica</i> 'Yoshino'	Yoshino Cyrtomeria
4	EA	CAL	<i>Cupressus arizonica</i> 'Carolina Sapphire'	Carolina Sapphire Cypress
	EA	INL	<i>Ilex X 'Nellie R Stevens'</i>	Nellie Stevens Holly
14	EA	JVL	<i>Juniperus virginiana</i>	Eastern Red Cedar
3	EA	MGL	<i>Magnolia grandiflora</i> 'D.D. Blancher'	D.D. Blancher Magnolia
Deciduous Trees (LARGE)				
3	EA	ABL	<i>Acer rubrum</i> 'Autumn Blaze'	Autumn Blaze Red Maple
7	EA	ARL	<i>Acer rubrum</i> 'October Glory'	October Glory Red Maple
7	EA	NSL	<i>Nyssa sylvatica</i> 'Wildfire'	Black Gum
7	EA	QAL	<i>Quercus alba</i>	White Oak
11	EA	QCL	<i>Quercus coccinea</i>	Scarlet Oak
11	EA	QSL	<i>Quercus shumardii</i>	Shumard Oak
2	EA	TDL	<i>Taxodium distichum</i>	Bald Cypress
Shrubs / Native Grass and Perennial Varieties				
	EA	EP	<i>Echinacea purpurea</i>	Purple Coneflower
5200	EA	ES	<i>Eragrostis spectabilis</i>	Purple Love Grass
700	EA	HB	<i>Hemerocallis 'Buttered Popcorn'</i>	Buttered Popcorn Daylily
1885	EA	ND	<i>Narcissus 'Dutch Master'</i>	Dutch Master Daffodil
3720	EA	NT	<i>Nassella tenuissima</i>	Mexican Feather Grass
280	EA	PV	<i>Panicum virgatum</i> 'Cloud Nine'	Cloud Nine Switchgrass
500	EA	RF	<i>Rudbeckia fulgida</i> 'Goldstrum'	Black Eyed Susan
1200	EA	SS	<i>Schizachyrium scoparium</i>	Little Bluestem



SHEET NO.
L2

PROJECT REF. NO.
I-0911A / Interstate 40

I-9911A Davie & Forsyth County
Interstate 40 Corridor Development, North Carolina



N.C. Department of Transportation
Roadside Environmental Unit - Aesthetic Engineering Section
Planting Plan

L2

3

07/09/97

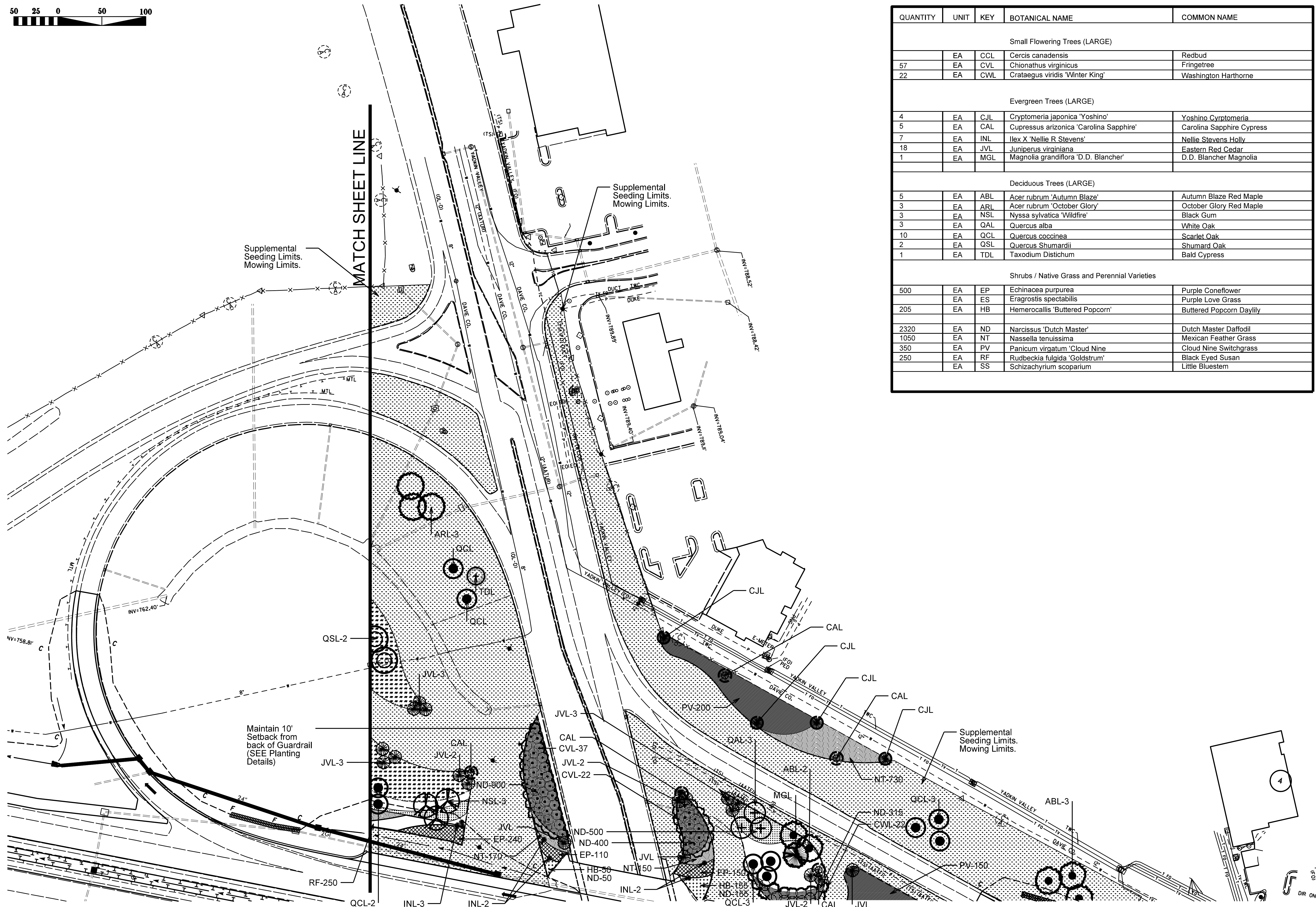

QUANTITY	UNIT	KEY	BOTANICAL NAME	COMMON NAME
Small Flowering Trees (LARGE)				
	EA	CCL	<i>Cercis canadensis</i>	Redbud
57	EA	CVL	<i>Chionathus virginicus</i>	Fringetree
22	EA	CWL	<i>Crataegus viridis</i> 'Winter King'	Washington Harthorne
Evergreen Trees (LARGE)				
4	EA	CJL	<i>Cryptomeria japonica</i> 'Yoshino'	Yoshino Cryptomeria
5	EA	CAL	<i>Cupressus arizonica</i> 'Carolina Sapphire'	Carolina Sapphire Cypress
7	EA	INL	<i>Ilex X 'Nellie R Stevens'</i>	Nellie Stevens Holly
18	EA	JVL	<i>Juniperus virginiana</i>	Eastern Red Cedar
1	EA	MGL	<i>Magnolia grandiflora</i> 'D.D. Blancher'	D.D. Blancher Magnolia
Deciduous Trees (LARGE)				
5	EA	ABL	<i>Acer rubrum</i> 'Autumn Blaze'	Autumn Blaze Red Maple
3	EA	ARL	<i>Acer rubrum</i> 'October Glory'	October Glory Red Maple
3	EA	NSL	<i>Nyssa sylvatica</i> 'Wildfire'	Black Gum
3	EA	QAL	<i>Quercus alba</i>	White Oak
10	EA	QCL	<i>Quercus coccinea</i>	Scarlet Oak
2	EA	QSL	<i>Quercus shumardii</i>	Shumard Oak
1	EA	TDL	<i>Taxodium distichum</i>	Bald Cypress
Shrubs / Native Grass and Perennial Varieties				
500	EA	EP	<i>Echinacea purpurea</i>	Purple Coneflower
	EA	ES	<i>Eragrostis spectabilis</i>	Purple Love Grass
205	EA	HB	<i>Hemerocallis</i> 'Buttered Popcorn'	Buttered Popcorn Daylily
2320	EA	ND	<i>Narcissus</i> 'Dutch Master'	Dutch Master Daffodil
1050	EA	NT	<i>Nassella tenuissima</i>	Mexican Feather Grass
350	EA	PV	<i>Panicum virgatum</i> 'Cloud Nine'	Cloud Nine Switchgrass
250	EA	RF	<i>Rudbeckia fulgida</i> 'Goldstrum'	Black Eyed Susan
	EA	SS	<i>Schizachyrium scoparium</i>	Little Bluestem

SHEET NO.
L3

PROJECT REF. NO.
I-0911A / Interstate 40

I-0911A Davie & Forsyth County
Interstate 40 Corridor Development, North Carolina



N.C. Department of Transportation
Roadside Environmental Unit - Aesthetic Engineering Section
Planting Plan

L3

07/09/97

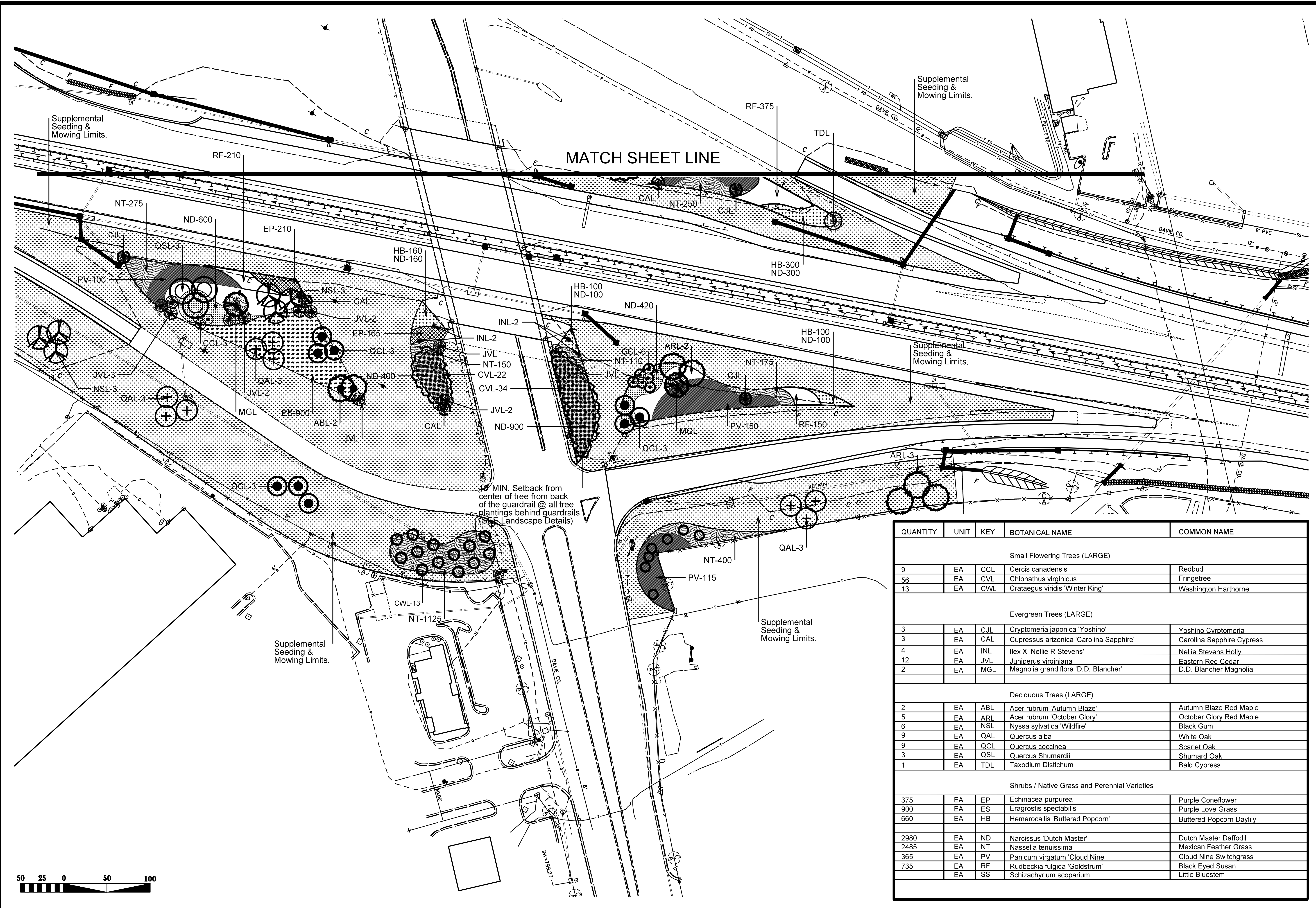
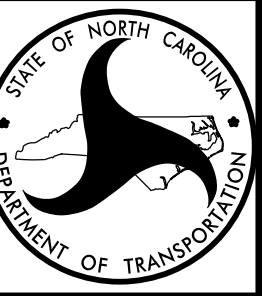

QUANTITY	UNIT	KEY	BOTANICAL NAME	COMMON NAME
Small Flowering Trees (LARGE)				
9	EA	CCL	<i>Cercis canadensis</i>	Redbud
56	EA	CVL	<i>Chionathus virginicus</i>	Fringetree
13	EA	CWL	<i>Crataegus viridis</i> 'Winter King'	Washington Harthorne
Evergreen Trees (LARGE)				
3	EA	CJL	<i>Cryptomeria japonica</i> 'Yoshino'	Yoshino Cyrtptomeria
3	EA	CAL	<i>Cupressus arizonica</i> 'Carolina Sapphire'	Carolina Sapphire Cypress
4	EA	INL	<i>Ilex X 'Nellie R Stevens'</i>	Nellie Stevens Holly
12	EA	JVL	<i>Juniperus virginiana</i>	Eastern Red Cedar
2	EA	MGL	<i>Magnolia grandiflora</i> 'D.D. Blancher'	D.D. Blancher Magnolia
Deciduous Trees (LARGE)				
2	EA	ABL	<i>Acer rubrum</i> 'Autumn Blaze'	Autumn Blaze Red Maple
5	EA	ARL	<i>Acer rubrum</i> 'October Glory'	October Glory Red Maple
6	EA	NSL	<i>Nyssa sylvatica</i> 'Wildfire'	Black Gum
9	EA	QAL	<i>Quercus alba</i>	White Oak
9	EA	QCL	<i>Quercus coccinea</i>	Scarlet Oak
3	EA	QSL	<i>Quercus shumardii</i>	Shumard Oak
1	EA	TDL	<i>Taxodium distichum</i>	Bald Cypress
Shrubs / Native Grass and Perennial Varieties				
375	EA	EP	<i>Echinacea purpurea</i>	Purple Coneflower
900	EA	ES	<i>Eragrostis spectabilis</i>	Purple Love Grass
660	EA	HB	<i>Hemerocallis</i> 'Buttered Popcorn'	Buttered Popcorn Daylily
2980	EA	ND	<i>Narcissus</i> 'Dutch Master'	Dutch Master Daffodil
2485	EA	NT	<i>Nassella tenuissima</i>	Mexican Feather Grass
365	EA	PV	<i>Panicum virgatum</i> 'Cloud Nine	Cloud Nine Switchgrass
735	EA	RF	<i>Rudbeckia fulgida</i> 'Goldstrum'	Black Eyed Susan
	EA	SS	<i>Schizachyrium scoparium</i>	Little Bluestem

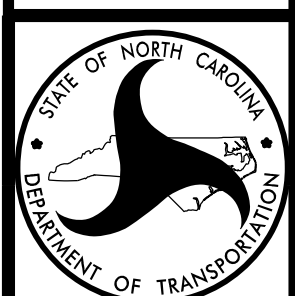

QUANTITY	UNIT	KEY	BOTANICAL NAME	COMMON NAME
Small Flowering Trees (LARGE)				
	EA	CCL	<i>Cercis canadensis</i>	Redbud
	EA	CVL	<i>Chionathus virginicus</i>	Fringetree
	EA	CWL	<i>Crataegus viridis</i> 'Winter King'	Washington Harthorne
Evergreen Trees (LARGE)				
	EA	CJL	<i>Cryptomeria japonica</i> 'Yoshino'	Yoshino Cryptomeria
9	EA	CAL	<i>Cupressus arizonica</i> 'Carolina Sapphire'	Carolina Sapphire Cypress
	EA	INL	<i>Ilex X</i> 'Nellie R Stevens'	Nellie Stevens Holly
12	EA	JVL	<i>Juniperus virginiana</i>	Eastern Red Cedar
	EA	MGL	<i>Magnolia grandiflora</i> 'D.D. Blancher'	D.D. Blancher Magnolia
	EA	PTL	<i>Pinus taeda</i>	Loblolly Pine
Deciduous Trees (LARGE)				
	EA	ABL	<i>Acer rubrum</i> 'Autumn Blaze'	Autumn Blaze Red Maple
	EA	ARL	<i>Acer rubrum</i> 'October Glory'	October Glory Red Maple
	EA	NSL	<i>Nyssa sylvatica</i> 'Wildfire'	Black Gum
	EA	QAL	<i>Quercus alba</i>	White Oak
	EA	QCL	<i>Quercus coccinea</i>	Scarlet Oak
	EA	QSL	<i>Quercus shumardii</i>	Shumard Oak
	EA	TDL	<i>Taxodium distichum</i>	Bald Cypress
Shrubs / Native Grass and Perennial Varieties				
	EA	EP	<i>Echinacea purpurea</i>	Purple Coneflower
	EA	ES	<i>Eragrostis spectabilis</i>	Purple Love Grass
3550	EA	HB	<i>Hemerocallis</i> 'Buttered Popcorn'	Buttered Popcorn Daylily
	EA	IV	<i>Illex verticillata</i> 'Red Sprite'	Red Sprite Winterberry
3550	EA	ND	<i>Narcissus</i> 'Dutch Master'	Dutch Master Daffodil
	EA	NT	<i>Nassella tenuissima</i>	Mexican Feather Grass
	EA	PV	<i>Panicum virgatum</i> 'Cloud Nine'	Cloud Nine Switchgrass
1390	EA	RF	<i>Rudbeckia fulgida</i> 'Goldstrum'	Black Eyed Susan
	EA	SS	<i>Schizachyrium scoparium</i>	Little Bluestem

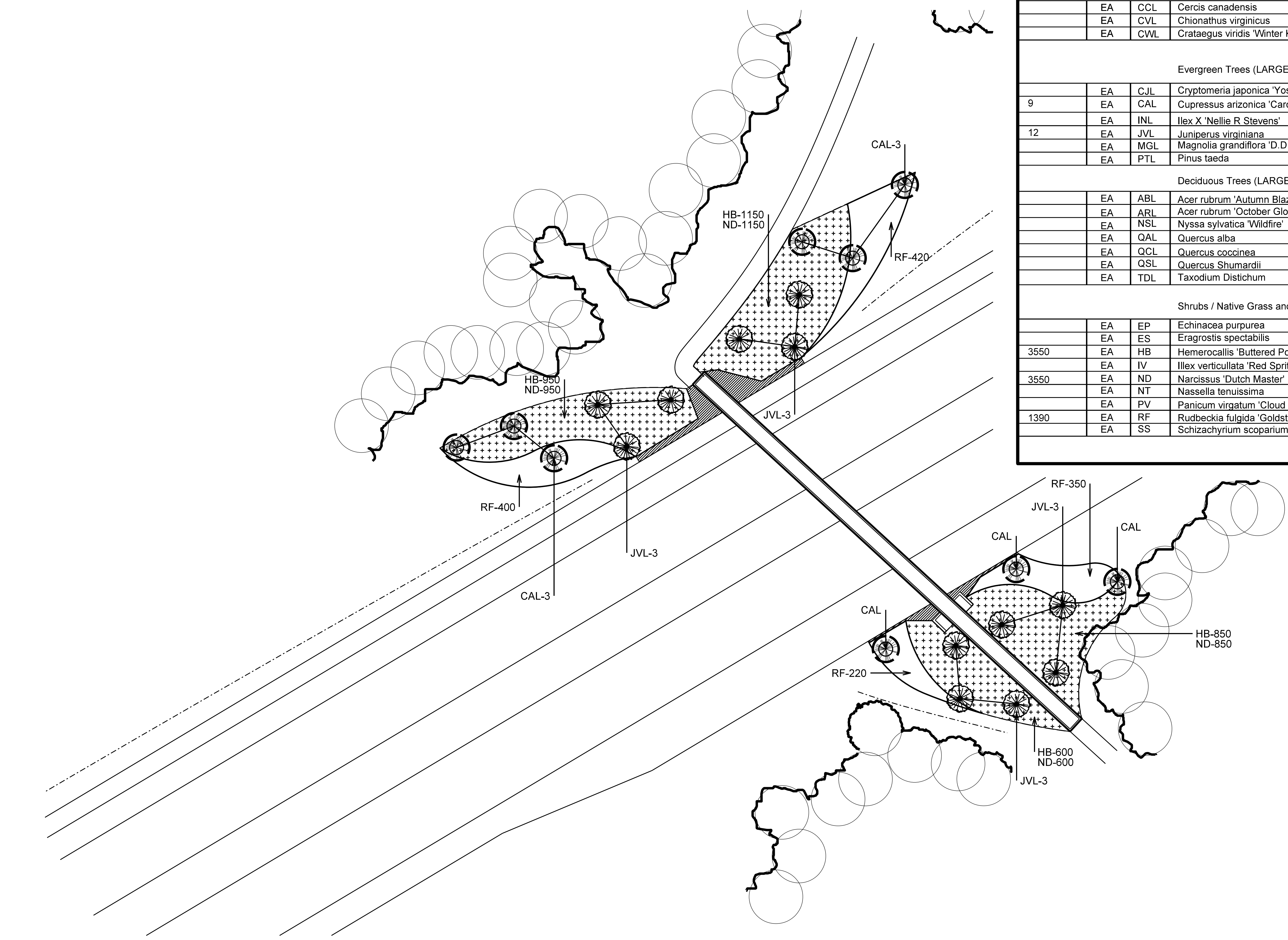

07/09/97

QUANTITY	UNIT	KEY	BOTANICAL NAME	COMMON NAME
Small Flowering Trees (LARGE)				
	EA	CCL	Cercis canadensis	Redbud
	EA	CVL	Chionathus virginicus	Fringetree
	EA	CWL	Crataegus viridis 'Winter King'	Washington Harthorne
Evergreen Trees (LARGE)				
9	EA	CJL	Cryptomeria japonica 'Yoshino'	Yoshino Cryptomeria
15	EA	CAL	Cupressus arizonica 'Carolina Sapphire'	Carolina Sapphire Cypress
	EA	INL	Ilex X 'Nellie R Stevens'	Nellie Stevens Holly
15	EA	JVL	Juniperus virginiana	Eastern Red Cedar
3	EA	MGL	Magnolia grandiflora 'D.D. Blancher'	D.D. Blancher Magnolia
	EA	PTL	Pinus taeda	Loblolly Pine
Deciduous Trees (LARGE)				
	EA	ABL	Acer rubrum 'Autumn Blaze'	Autumn Blaze Red Maple
	EA	ARL	Acer rubrum 'October Glory'	October Glory Red Maple
	EA	NSL	Nyssa sylvatica 'Wildfire'	Black Gum
	EA	QAL	Quercus alba	White Oak
	EA	QCL	Quercus coccinea	Scarlet Oak
	EA	QSL	Quercus shumardii	Shumard Oak
	EA	TDL	Taxodium distichum	Bald Cypress
Shrubs / Native Grass and Perennial Varieties				
	EA	EP	Echinacea purpurea	Purple Coneflower
	EA	ES	Eragrostis spectabilis	Purple Love Grass
	EA	HB	Hemerocallis 'Buttered Popcorn'	Buttered Popcorn Daylily
	EA	IV	Ilex verticillata 'Red Sprite'	Red Sprite Winterberry
	EA	ND	Narcissus 'Dutch Master'	Dutch Master Daffodil
	EA	NT	Nassella tenuissima	Mexican Feather Grass
	EA	PV	Panicum virgatum 'Cloud Nine'	Cloud Nine Switchgrass
	EA	RF	Rudbeckia fulgida 'Goldstrum'	Black Eyed Susan
	EA	SS	Schizachyrium scoparium	Little Bluestem

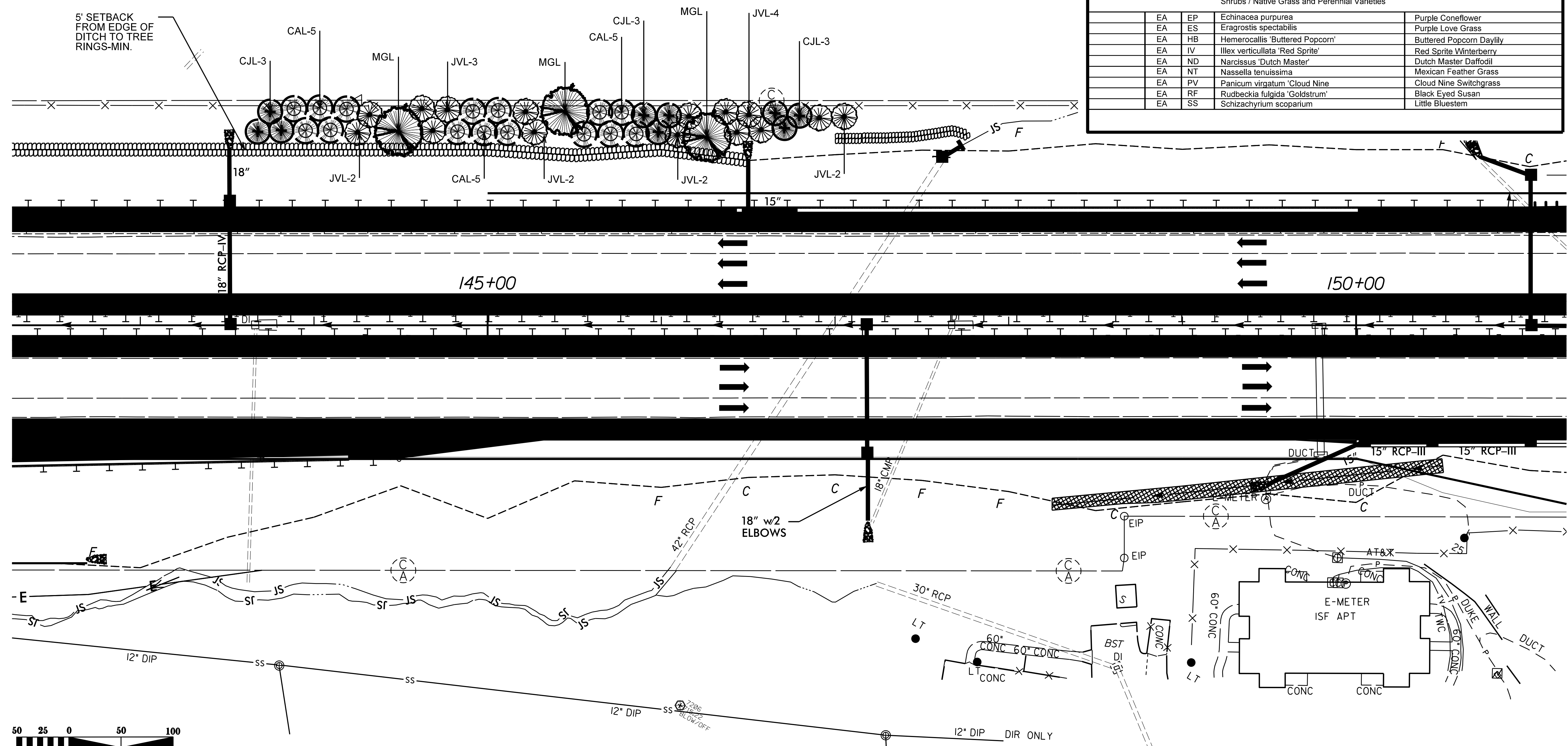

SHEET NO.
L6

PROJECT REF. NO.
I-0911A / Interstate 40

I-0911A Davie & Forsyth County
Interstate 40 Corridor Development, North Carolina



N.C. Department of Transportation
Roadside Environmental Unit - Aesthetic Engineering Section
Planting Plan (Peony Way Screening)

L6

07/09/97

SHEET NO.
L7
PROJECT REF. NO.
I-0911A / Interstate 40

I-0911A Davie & Forsyth County
Interstate 40 Corridor Development, North Carolina

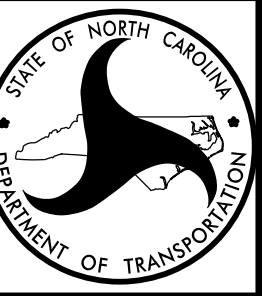

N.C. Department of Transportation
Roadside Environmental Unit - Aesthetic Engineering Section
Planting Plan

L7

QUANTITY	UNIT	KEY	BOTANICAL NAME	COMMON NAME
Small Flowering Trees (LARGE)				
	EA	CCL	<i>Cercis canadensis</i>	Redbud
	EA	CVL	<i>Chionathus virginicus</i>	Fringetree
	EA	CWL	<i>Crataegus viridis</i> 'Winter King'	Washington Harthorne
Evergreen Trees (LARGE)				
51	EA	CJL	<i>Cryptomeria japonica</i> 'Yoshino'	Yoshino Cryptomeria
46	EA	CAL	<i>Cupressus arizonica</i> 'Carolina Sapphire'	Carolina Sapphire Cypress
	EA	INL	<i>Ilex X 'Nellie R Stevens'</i>	Nellie Stevens Holly
58	EA	JVL	<i>Juniperus virginiana</i>	Eastern Red Cedar
3	EA	MGL	<i>Magnolia grandiflora</i> 'D.D. Blancher'	D.D. Blancher Magnolia
	EA	PTL	<i>Pinus taeda</i>	Loblolly Pine
Deciduous Trees (LARGE)				
	EA	ABL	<i>Acer rubrum</i> 'Autumn Blaze'	Autumn Blaze Red Maple
	EA	ARL	<i>Acer rubrum</i> 'October Glory'	October Glory Red Maple
6	EA	NSL	<i>Nyssa sylvatica</i> 'Wildfire'	Black Gum
6	EA	QAL	<i>Quercus alba</i>	White Oak
6	EA	QCL	<i>Quercus coccinea</i>	Scarlet Oak
5	EA	QSL	<i>Quercus shumardii</i>	Shumard Oak
8	EA	TDL	<i>Taxodium distichum</i>	Bald Cypress
Shrubs / Native Grass and Perennial Varieties				
	EA	EP	<i>Echinacea purpurea</i>	Purple Coneflower
	EA	ES	<i>Eragrostis spectabilis</i>	Purple Love Grass
	EA	HB	<i>Heemerocallis</i> 'Buttered Popcorn'	Buttered Popcorn Daylily
	EA	IV	<i>Illex verticillata</i> 'Red Sprite'	Red Sprite Winterberry
	EA	ND	<i>Narcissus</i> 'Dutch Master'	Dutch Master Daffodil
	EA	NT	<i>Nassella tenuissima</i>	Mexican Feather Grass
	EA	PV	<i>Panicum virgatum</i> 'Cloud Nine'	Cloud Nine Switchgrass
	EA	RF	<i>Rudbeckia fulgida</i> 'Goldstrum'	Black Eyed Susan
	EA	SS	<i>Schizachyrium scoparium</i>	Little Bluestem

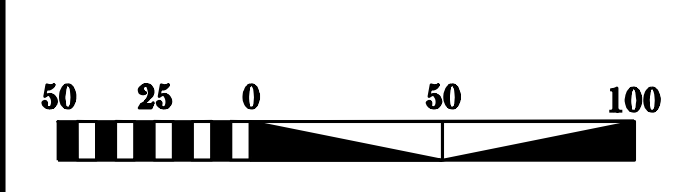
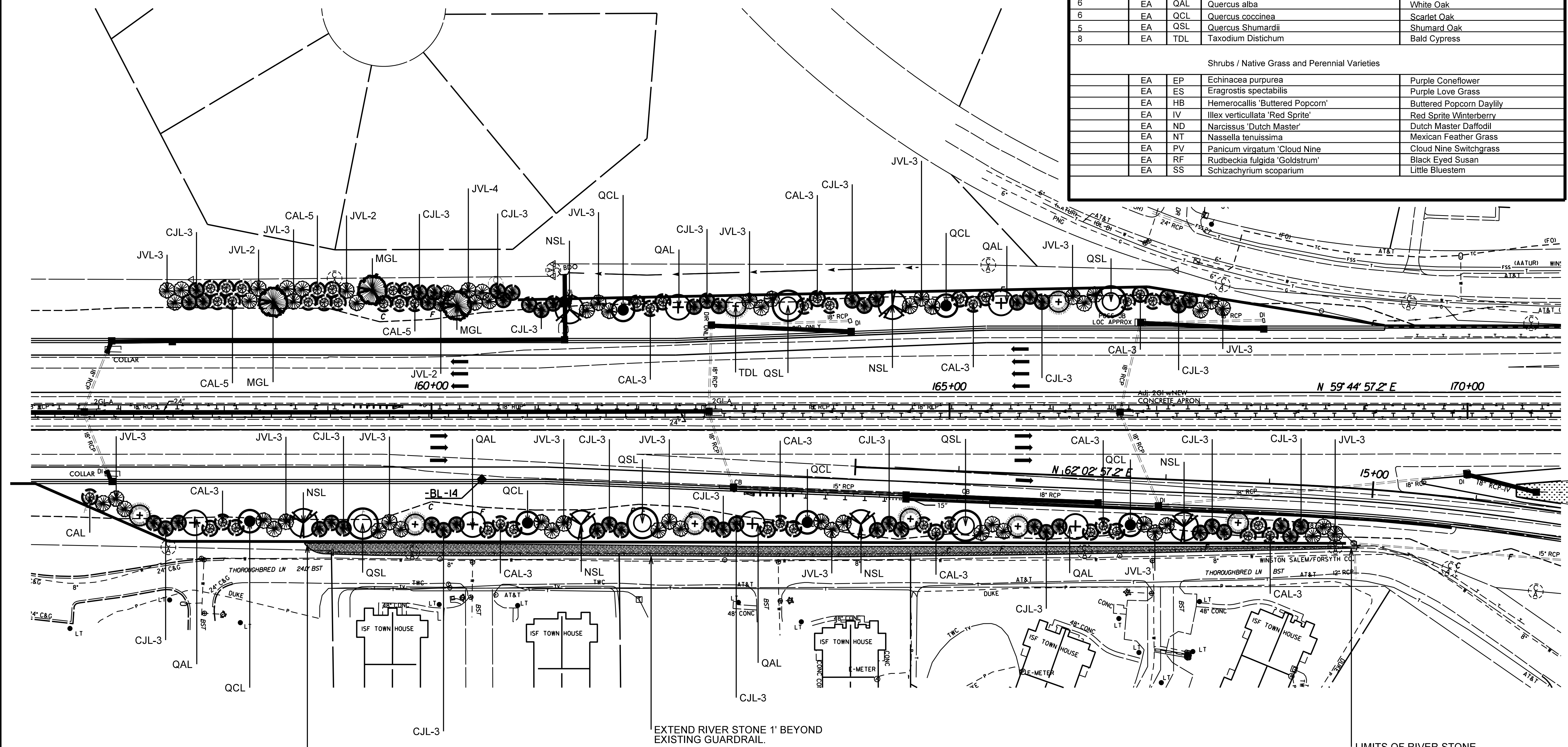

LIMITS OF RIVER STONE.
SEE SP FOR DETAILS. CONSULT
WITH ENGINEER IN THE FIELD TO
ADJUST FOR GUARDRAIL AND
EXISTING DITCH. (165 CY) 6" DEEP
INSTALL.

LIMITS OF RIVER STONE.
SEE SP FOR DETAILS. CONSULT
WITH ENGINEER IN THE FIELD TO
ADJUST FOR GUARDRAIL AND
EXISTING DITCH. (165 CY) 6" DEEP
INSTALL.

07/09/97

QUANTITY	UNIT	KEY	BOTANICAL NAME	COMMON NAME
Small Flowering Trees (LARGE)				
68	EA	CCL	<i>Cercis canadensis</i>	Redbud
	EA	CVL	<i>Chionathus virginicus</i>	Fringetree
28	EA	CWL	<i>Crataegus viridis</i> 'Winter King'	Washington Harthorne
Evergreen Trees (LARGE)				
2	EA	CJL	<i>Cryptomeria japonica</i> 'Yoshino'	Yoshino Cryptomeria
6	EA	CAL	<i>Cupressus arizonica</i> 'Carolina Sapphire'	Carolina Sapphire Cypress
4	EA	INL	<i>Ilex X 'Nellie R Stevens'</i>	Nellie Stevens Holly
28	EA	JVL	<i>Juniperus virginiana</i>	Eastern Red Cedar
4	EA	MGL	<i>Magnolia grandiflora</i> 'D.D. Blancher'	D.D. Blancher Magnolia
Deciduous Trees (LARGE)				
4	EA	ABL	<i>Acer rubrum</i> 'Autumn Blaze'	Autumn Blaze Red Maple
	EA	ARL	<i>Acer rubrum</i> 'October Glory'	October Glory Red Maple
	EA	NSL	<i>Nyssa sylvatica</i> 'Wildfire'	Black Gum
9	EA	QAL	<i>Quercus alba</i>	White Oak
	EA	QCL	<i>Quercus coccinea</i>	Scarlet Oak
4	EA	QSL	<i>Quercus shumardii</i>	Shumard Oak
8	EA	TDL	<i>Taxodium distichum</i>	Bald Cypress
Shrubs / Native Grass and Perennial Varieties				
410	EA	EP	<i>Echinacea purpurea</i>	Purple Coneflower
	EA	ES	<i>Eragrostis spectabilis</i>	Purple Love Grass
2025	EA	HB	<i>Heremacallis</i> 'Buttered Popcorn'	Buttered Popcorn Daylily
5060	EA	ND	<i>Narcissus</i> 'Dutch Master'	Dutch Master Daffodil
3550	EA	NT	<i>Nassella tenuissima</i>	Mexican Feather Grass
385	EA	PV	<i>Panicum virgatum</i> 'Cloud Nine'	Cloud Nine Switchgrass
270	EA	RF	<i>Rudbeckia fulgida</i> 'Goldstrum'	Black Eyed Susan
	EA	SS	<i>Schizachyrium scoparium</i>	Little Bluestem

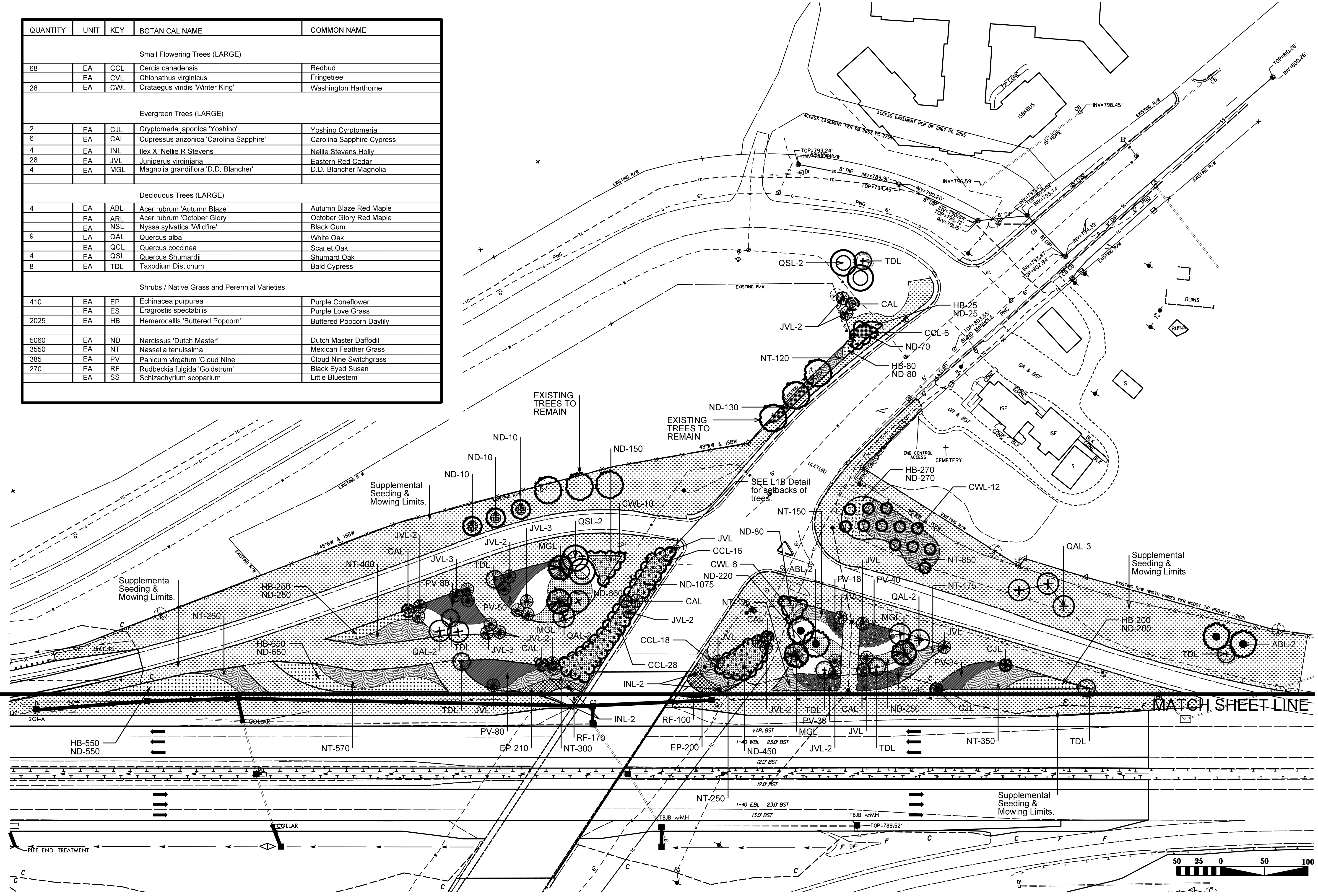

SHEET NO. L8

PROJECT REF. NO. I-0911A / Interstate 40

I-0911A Davie & Forsyth County Interstate 40 Corridor Development, North Carolina

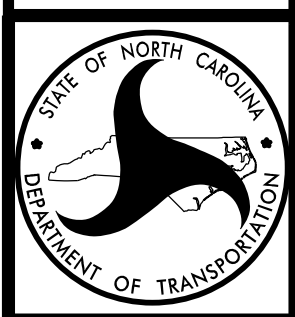

N.C. Department of Transportation
Roadside Environmental Unit - Aesthetic Engineering Section
Planting Plan

L8



07/09/97

HILLSDALE GROUP LLC
DB 186 PG 303

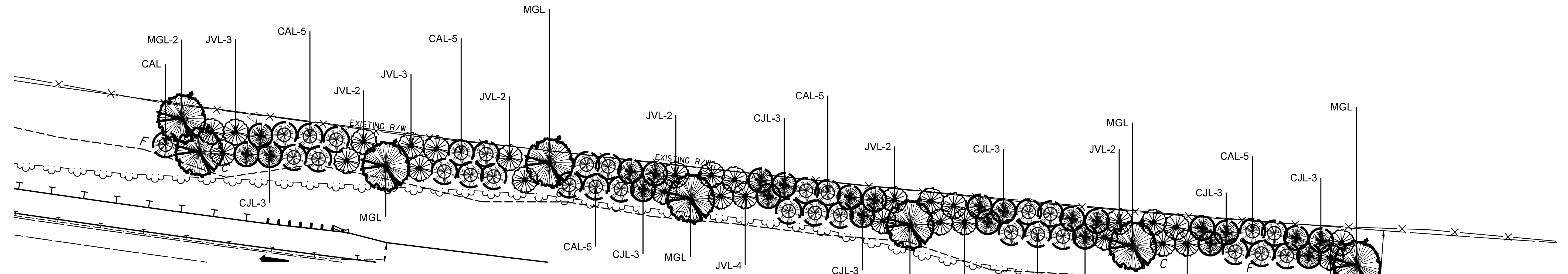

QUANTITY	UNIT	KEY	BOTANICAL NAME	COMMON NAME
Small Flowering Trees (LARGE)				
	EA	CCL	<i>Cercis canadensis</i>	Redbud
	EA	CVL	<i>Chionathus virginicus</i>	Fringetree
	EA	CWL	<i>Crataegus viridis</i> 'Winter King'	Washington Harthorne
Evergreen Trees (LARGE)				
24	EA	CJL	<i>Cryptomeria japonica</i> 'Yoshino'	Yoshino Cyrtomeria
31	EA	CAL	<i>Cupressus arizonica</i> 'Carolina Sapphire'	Carolina Sapphire Cypress
	EA	INL	<i>Ilex X 'Nellie R Stevens'</i>	Nellie Stevens Holly
30	EA	JVL	<i>Juniperus virginiana</i>	Eastern Red Cedar
8	EA	MGL	<i>Magnolia grandiflora</i> 'D.D. Blancher'	D.D. Blancher Magnolia
	EA	PTL	<i>Pinus taeda</i>	Loblolly Pine
Deciduous Trees (LARGE)				
	EA	ABL	<i>Acer rubrum</i> 'Autumn Blaze'	Autumn Blaze Red Maple
	EA	ARL	<i>Acer rubrum</i> 'October Glory'	October Glory Red Maple
	EA	NSL	<i>Nyssa sylvatica</i> 'Wildfire'	Black Gum
	EA	QAL	<i>Quercus alba</i>	White Oak
	EA	QCL	<i>Quercus coccinea</i>	Scarlet Oak
	EA	QSL	<i>Quercus Shumardii</i>	Shumard Oak
	EA	TDL	<i>Taxodium Distichum</i>	Bald Cypress
Shrubs / Native Grass and Perennial Varieties				
	EA	EP	<i>Echinacea purpurea</i>	Purple Coneflower
	EA	ES	<i>Eragrostis spectabilis</i>	Purple Love Grass
	EA	HB	<i>Hemerocallis</i> 'Buttered Popcorn'	Buttered Popcorn Daylily
	EA	IV	<i>Illex verticillata</i> 'Red Sprite'	Red Sprite Winterberry
	EA	ND	<i>Narcissus</i> 'Dutch Master'	Dutch Master Daffodil
	EA	NT	<i>Nassella tenuissima</i>	Mexican Feather Grass
	EA	PV	<i>Panicum virgatum</i> 'Cloud Nine	Cloud Nine Switchgrass
	EA	RF	<i>Rudbeckia fulgida</i> 'Goldstrum'	Black Eyed Susan
	EA	SS	<i>Schizachyrium scoparium</i>	Little Bluestem

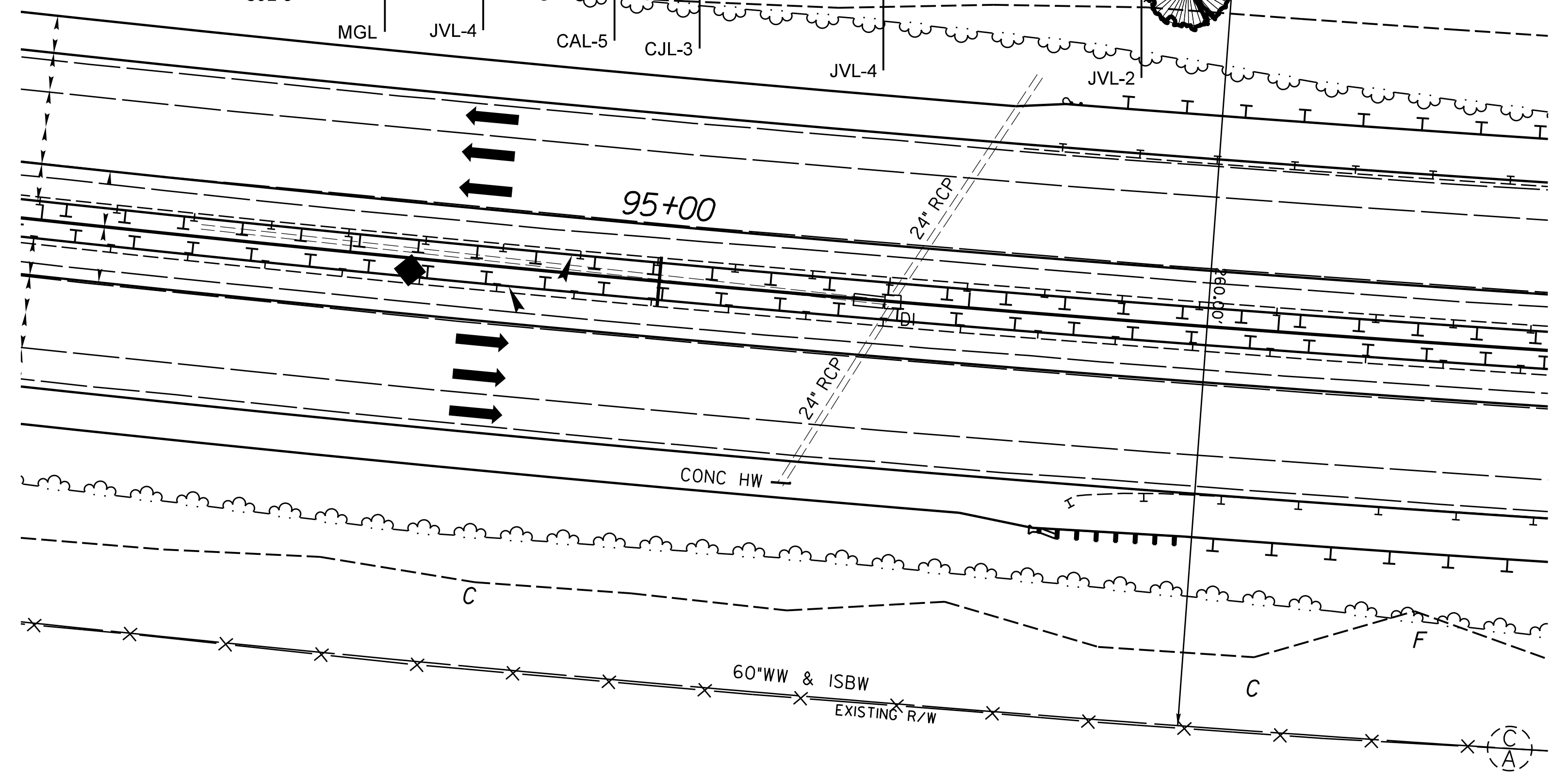

SHEET NO.
L10

PROJECT REF. NO.
I-0911A / Interstate 40

I-0911A Davie & Forsyth County
Interstate 40 Corridor Development, North Carolina



N.C. Department of Transportation
Roadside Environmental Unit - Aesthetic Engineering Section
Planting Plan

L10